RELIABLE FLOORING INSTALLATION SYSTEMS



SYSTEMARDEX
PREMIUM PERFORMANCE



THE PERFECT FLOOR

At ARDEX, we understand the challenges of achieving the perfect flooring. Various factors must be considered, such as substrate preparation, material selection for different environments, installation intricacies, wear resistance, long-term performance and aesthetics.

Our range of high-performance flooring products is designed to provide you with peace of mind and confidence in the longevity and reliability of installing all types of resilient floor finishes. We have developed, tested, and approved our products to be fully compatible with today's most popular floor coverings, offering reassurance and ease in installations. Moreover, our products are also green-certified with low volatile organic compounds (VOCs) that help to maintain healthy living and safety against indoor air pollution.

We are committed to excellence across all aspects of our flooring solutions, including repair mortar, moisture protection, screeds, primer, smoothing compounds, and flooring adhesives. Our comprehensive installation system ensures superior quality, durability, and performance.

Whether you're walking down the treating patients in a hospital, corridors of a school, welcoming guests in a hotel, conducting business in an office, or relaxing at home, the ARDEX flooring system offers unmatched reliability and a sturdy base.

Experience the difference with ARDEX Flooring Solutions and discover why we're the preferred choice for healthcare, education, hospitality, office spaces, and residential segments worldwide.



REPAIR



PROTECT



SCREEDS



PRIMER

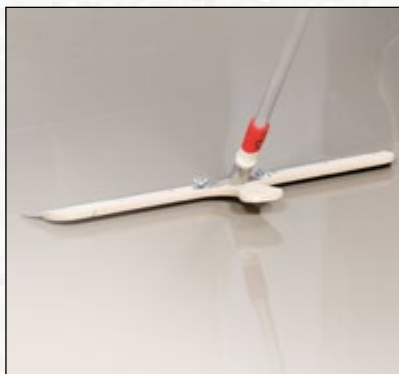

SMOOTH & LEVEL



FLOORING ADHESIVE



GET READY FOR A SUSTAINABLE SOLUTION FOR DIVERSE MARKET SEGMENTS



HOSPITALITY

Within the intricate realm of hospitality, where the delicate balance between aesthetics and durability is paramount to success, our flooring systems provide a fast and effective solution for newly built or renovation projects with various floor finishings like Luxury Vinyl Tiles, Carpets, Engineer Woods etc.

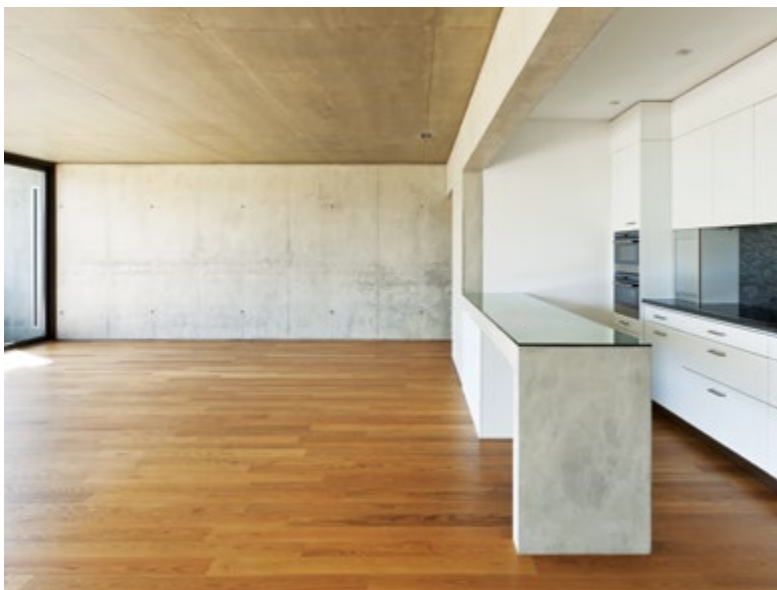

RESIDENTIAL

In residential settings, where comfort and style are paramount, our flooring solutions offer a wide range of options to suit every site condition and budget for installing large-format tiles, luxurious hardwoods, and durable types of vinyl.

No matter the segment, ARDEX Flooring Solutions are committed to delivering excellence in quality, durability, and performance, ensuring that your flooring investment stands the test of time and enhances the beauty and functionality of your space for years to come.



EDUCATIONAL

Our flooring solutions are specifically designed to withstand the heavy foot traffic and frequent use common in educational settings. We are confident that our solutions create a clean and inviting environment conducive to learning. We firmly believe that our flooring solutions can help achieve that goal and stand behind them confidently.



HEALTHCARE

Within healthcare environments, where upholding hygiene and safety standards is imperative, our flooring solutions present firm and sturdy surfaces that facilitate effortless maintenance, functionality, and flawlessly resilient flooring. This commitment guarantees a secure environment for patients, staff and medical equipment, characterised by consistently flat and smooth surfaces throughout.



OFFICE SPACES

The demand for Luxury Vinyl tile floor finishes is increasing in office spaces, where productivity and comfort are essential. ARDEX Flooring Solutions provides a professional and guaranteed subfloor and flooring system to enhance the working environment while meeting the demands of modern business.

SOFT FLOORCOVERING INSTALLATION SYSTEMS



When it comes to flooring, the appropriate products and system can vary significantly between refurbished and newly built options. Understanding the necessary treatment requirements of each type will help ensure their longevity and appearance.

A strong bond between the substrate and the ARDEX topping is crucial for successfully installing ARDEX products. Concrete floors must be clean, sound, and free from foreign contaminants through mechanical preparation. Unprepared and contaminated slabs are the leading causes of expensive and preventable failures. All substrates must be evaluated and tested for moisture. A moisture barrier must be applied first if the moisture level exceeds 5% or 75% relative humidity (RH).

If the RH readings on your floor are between 75% and 95% and there is a functioning structural damp-proof membrane, we recommend using the ARDEX WPM 300 system. If the RH readings are up to 98%, we suggest using the ARDEX DPM system.

If your floor's RH readings are below 75%, we recommend using ARDEX P 51 Primer.

All cracked, damaged, or honeycombed surfaces shall be repaired with a suitable repair mortar before proceeding with subsequent stages of work. Patch small pockets of the uneven surface with repair mortar or an approved equivalent.

Levelling compounds should be applied by experienced flooring installers who will test for "Planeness" and "Smoothness" according to BS8204 standards. Planeness should not be less than 3 mm under a 2 m straight edge. If the floors do not meet the standard of planeness, a flood coat of 3mm or more of ARDEX Self-levelling Smoothing Compound should be applied. If the floor is 'Plane' but not 'Smooth', ARDEX Feather Finish rapid-drying smoothing compound should be used.

FLOORING ADHESIVE

Selecting the appropriate adhesives for your floor covering is crucial, as each type of flooring material requires specific adhesion properties. Failing to use the proper adhesive can potentially void your flooring warranty and compromise its performance. There are different types of adhesives and installation methods. The common types are either wet sets or pressure-sensitive adhesives. Wet sets are applied with a trowel while wet, and once they are set, they cured to a hard state, making the flooring unmovable. Drying can take as little as 24 hours, while complete curing can take up to 30 days. The key point is that the product will not be repositionable after drying.

On the other hand, pressure-sensitive adhesives take around 30 minutes to become tacky, allowing for repositioning of the flooring. This feature makes the installation of LVT with many seams easier. Unlike wet sets, there's no tendency for the adhesive to emerge through the seams, leading to less cleanup.

For high-strength adhesives, consider the urethane option. It forms a chemical bond with concrete and floor covering, creating a strong yet flexible hold. This flooring adhesive is also moisture-resistant.

Work with ARDEX to ensure you find the right combination of adhesive and flooring products and follow the correct installation guidelines for optimum performance.

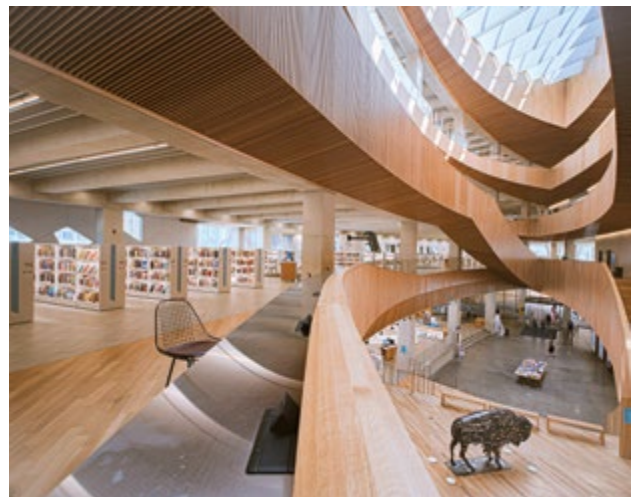

REPAIR / SMOOTHING PATCHING COMPOUND

ARDEX A 46 MULTI-PURPOSE REPAIR MORTAR



ARDEX A 46 is a rapid setting and hardening, slump-free mortar ideal for external or internal repairs. The mortar sets and hardens rapidly, providing a repair of exceptional strength and hardness.

ARDEX FEATHER FINISH RAPID DRYING PATCHING AND SMOOTHING COMPOUND



ARDEX Feather Finish™ is formulated to efficiently smooth surfaces by filling imperfections without the need to build a skim coat over the entire surface, ensuring three times the coverage of sanded skimming products. Needing no priming and with Ardurapid fast-dry technology, ARDEX Feather Finish™ is ready to receive floor coverings in as little as 15 minutes.

ARDEX SKM SKIMCOAT PATCH AND FINISHING UNDERLAYMENT



ARDEX SKM is a Skim Finish - Skim Coat Patch & Finishing Underlayment that provides a permanent, smooth, durable finish prior to the installation of floor coverings. It hardens quickly, is very easy to apply, and dries fast without shrinkage.

PRIMER

ARDEX P 4 READY MIXED RAPID DRYING PRIMER



ARDEX P 4 is a ready-mixed primer for use on absorbent and non-absorbent backgrounds in internal and external locations. It produces a textured surface that is especially effective in facilitating the adhesion of cement-based tile adhesives in tile-on-tile applications.

ARDEX P 51 CONCENTRATED WATER-BASED PRIMER AND BONDING AGENT



ARDEX P 51 is a water-based primer, precoat, bonding agent, and pore closer for concrete substrates. It is used to prevent air bubbles rising through subsequently applied sub-floor smoothing and levelling compounds and to prolong their flow life and workability. Only for use as a primer on floors that are dry and have an effective damp proof membrane.

ARDEX P 82 WATER DISPERSED EPOXY PRIMER



ARDEX P 82 is a water-based, two-component synthetic resin primer and bonding agent for the application of ARDEX Underlayments on dense and smooth substrates. Substrates include >35MPa concrete, wood and wood-based panels, terrazzo, glazed and quarry tiles, and steel decking.

MOISTURE BARRIER PROTECTION

ARDEX WPM 300

SUBSTRATE MOISTURE BARRIER AND GREEN SLAB PRIMER



ARDEX WPM 300 is an epoxy moisture barrier that suppresses excessive moisture vapor in new or existing concrete slabs. It safeguards your floor, saves time and money by fast-tracking projects, and eliminates the need for expensive moisture tests or waiting for slabs to dry. With great coverage and a fast spread rate, ARDEX WPM 300 is cost-effective, non-flammable, and has minimal odor, making it safe for internal use.

ARDEX DPM

SURFACE DAMP PROOF MEMBRANE - RESIDUAL MOISTURE SUPPRESSANT



ARDEX DPM is solvent-free, low-viscosity, two-component epoxy resin. After hardening, the ARDEX DPM produces a membrane with high inherent strength and excellent bond strength to appropriate substrates, including very damp concrete and screeds.

FLOOR TOPPING (>15MM)

ARDEX A 35

RAPID SETTING AND ULTRA RAPID DRYING CEMENT FOR FLOOR SCREEDS



ARDEX A 35 incorporates ARDEX RAPIDRY FORMULA Technology which produces a floor screed that can be walked on after just 3 hours and is dry enough to receive floor coverings after 24 hours regardless of thickness. After 1 day, the compressive and tensile strengths of ARDEX A 35 exceed the acceptable minimum attained by a conventional screed after 28 days.

ARDEX A 65

HEAVY DUTY INDUSTRIAL SCREED TOPPING

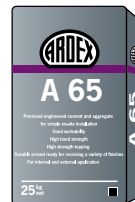

ARDEX A 65 is a high-performance, single-component, engineered cement screed incorporated with fiber and low dust technology. Designed for heavy-duty use in commercial and industrial areas subject to high load and traffic, ARDEX A 65 improves on-site efficiencies by providing superior workability and ensuring consistent quality and mix.

SELF-LEVELLING & SMOOTHING COMPOUND

ARDEX CL 1 FLOOR LEVELLING COMPOUND

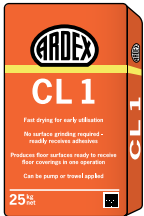

ARDEX CL 1 has been especially designed to produce a smooth, flat surface when applied to hard, rigid sub-floors such as sand/cement screeds, concrete etc. ARDEX CL 1 contains high quality synthetic resins, special cements and selected fillers so that, when mixed with water, a fluid easily trowelled mortar with free-flowing properties is produced

ARDEX K 310 SELF-LEVELLING SMOOTHING COMPOUND AS UNDERLAYMENT

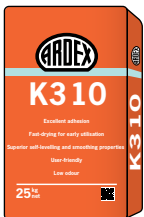

ARDEX K 310 is a single component, fast-setting, self-levelling and smoothing compound with built-in synthetic latex polymer. Suitable for preparing interior floors prior to laying parquet, vinyl sheet and tile, soft floor coverings, natural stone, ceramic tiles etc. It can be used on a wide range of absorbent and non-absorbent substrates including concrete, cement, sand screeds and ceramic.

ARDEX K 200 FIBRE-REINFORCED SELF-LEVELLING UNDERLAYMENT



ARDEX K 200 is a cement-based, pumpable, fibre-reinforced self-levelling underlayment for fast-track application with high surface strength. It is walkable after 3 - 4 hours. The mixed mortar can be applied at 4 - 15mm in one application.

FLOORING ADHESIVE

ARDEX AF 148 ALL PURPOSE FLOORING ADHESIVE

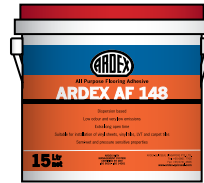

ARDEX AF 148 is a single-component, dispersion-based adhesive for laying LVT, PVC and VCT floorings in sheets, tiles, planks and carpet tiles on internal levelled subfloors. It can be used as semi-wet and pressure-sensitive. It has a long working time of up to 180 minutes.

ARDEX AF 2365 UNIVERSAL FLOORING ADHESIVE



ARDEX AF 2365 is water-based, low odour, solvent-free, acrylic, emulsion-based floor covering adhesive for wide range of floor coverings. ARDEX AF 2365 meets the requirement guidelines for the Singapore Green Building Council, achieving the lowest possible emission limits.

ARDEX AF 2510 TWO COMPONENT POLYURETHANE ADHESIVE



ARDEX AF 2510 is a two-part polyurethane adhesive for PVC, polyolefin planks and tiles, linoleum, rubber, and hardwood floor coverings. It becomes water-resistant when fully cured and is virtually emission-free, allowing thin PVC flooring to be installed without bubbling.



Singapore

ARDEX-QUICSEAL SINGAPORE PTE. LTD.

No. 7 Eunos Avenue 8A
Singapore 409460
Tel: +65 6861 7700
Fax: +65 6741 4666
Email: sales@ardex-quickseal.com

SINGAPORE PLANT

No. 26 Tuas Avenue 4
Singapore 639376
Fax: +65 6862 3381

Malaysia

ARDEX QUICSEAL MALAYSIA SDN. BHD.

(Sales & Marketing Office)

72-2, Jalan Puteri 2/2
Bandar Puteri, 47100 Puchong,
Selangor Darul Ehsan
Tel: +603 8051 0311
Email: sales.malaysia@ardex-quickseal.com

MALAYSIA PLANT

No 15 Jalan Desa Tropika 2/2,
Taman Perindustrian Tropika,
81800 Ulu Tiram, Johor
Tel: +607 8620 833, +607 8760 633
Fax: +607 8620 793

Thailand

ARDEX (THAILAND) CO., LTD

969 2nd Floor Moo, 13, Soi 45, Bangna-Trad Road Bangkaew,
Bangplee, Samutprakarn 10540
Thailand
Tel: +66 2316 3069
Fax: +66 2316 3075
Email: sales@ardex.co.th

Vietnam

Mobile: +84 901 351 308
Email: sales@ardex-quickseal.com

www.ardex-quickseal.com



RELIABLE FLOORING
INSTALLATION SYSTEMS

https://ardex.com.sg/products_category/floor-levelling/

